

DELEGATED DECISION

REGENERATION AND ECONOMIC DEVELOPMENT



AUGUST 2017

Asset Adoption Agreement and Associated Land Transfers

Report of Gerard Darby, Assets Services Manager

Purpose of the Report

- 1 To approve rights in land to be granted from Durham County Council (DCC) to Northern Power Grid (NPG) to facilitate the adoption and energisation of a substation.

Background

- 2 The Council has recently obtained circa £13m worth of funding from the North East Local Enterprise Partnership which has been utilised to provide road infrastructure and utility infrastructure to Forrest Park. As part of these works an electrical substation has been built on land owned by the Council via contractors Morrison Utility Services (MUS).
- 3 The substation is to be adopted by NPG in order for it to be energised and as such the following agreements need to be entered into:
 - a) Asset Adoption Agreement.- This facilitates the substation and apparatus to be adopted by NPG.
 - b) Transfer of the land that the substation is situated on (as shown verged red on the attached plan) from DCC to NPG with associated access rights.
 - c) Agreement that land surrounding the substation will be retained by the Council, in order to enforce required covenants with an acceptance that any matters and actions required for management and development of the substation by NPG shall be permitted. This land is showed verged yellow on the attached plan.
- 4 It is understood that the power cable route as shown green on the attached plan, into the substation is all within adopted highway, so no easement are required.

Decision

- 5 Delegated authority to be approved to enter into:
 - a) The required asset adoption agreement
 - b) Transfer the substation land

Contact: Andrew Holtham Tel: 03000 267199

Appendix 1: Implications

Finance – No premium payable. Both parties to pay own costs.

Staffing - N/A

Risk - N/A

Equality and Diversity / Public Sector Equality Duty - N/A

Accommodation - N/A

Crime and Disorder - N/A

Human Rights - N/A

Consultation - Councillor Kevin Shaw as Portfolio Holder together with Local Councillors Sarah Iveson and Jim Atkinson were consulted on 4th August 2017.

Procurement – N/A

Disability Issues - N/A

Legal Implications - N/A

1. Access Land is Access necessary
2. Retained Land

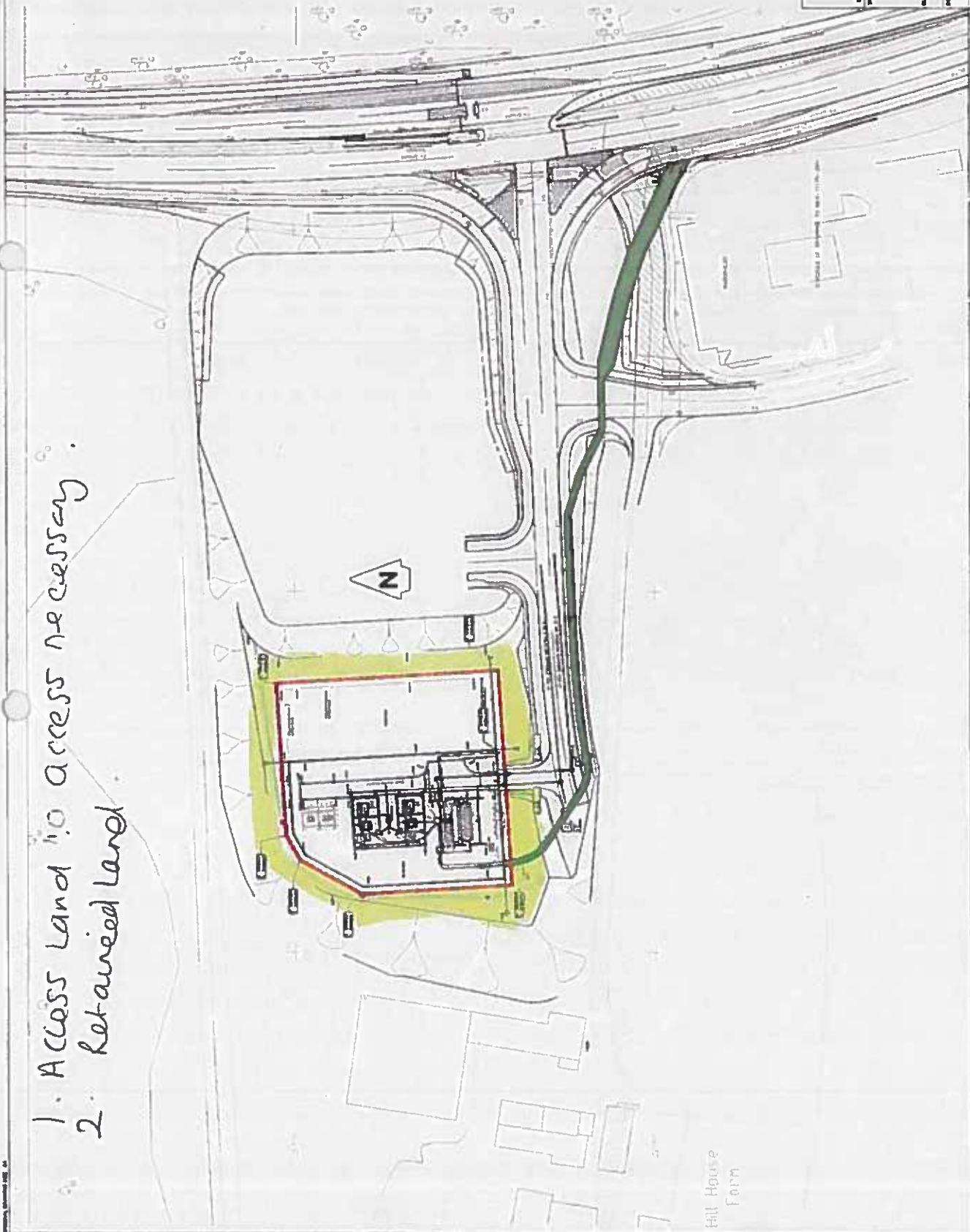

MORRISON
Utility Connections

ATCLIFFE FOREST 33/11KV & 5
NEW 33/11KV SUBSTATION

NORTHERN
POWERGEN

PLAN FOR LAND ADOPTION AGREEMENT

INFORMATION

Scale	1:500
Sheet	1 of 2
Date	12/08
Author	A
Checker	A

WEST FLORES
MIDLESEX COUNTY
COUNCIL
10/11/08

Hill House
Farm

SCALE FOR INFORMATION